



COMUNE DI PADOVA

AREA LL.PP.

Settore Opere Infrastrutturali Manutenzioni e Arredo urbano

Servizio Manutenzioni

Elenco annuale Anno 2017

PROGETTO ESECUTIVO

Manutenzione straordinaria della segnaletica
stradale orizzontale e verticale nella Z.T.L.
e per ordinanze di viabilità Lotto 3 - anno 2017

Importo complessivo del progetto €. 100.000,00

N° Progetto LLPP_OPI_2017/030-003 Nome File Data	CUP LLPP INF2017/	Elaborato 8 ELABORATI GRAFICI TIPOLOGIE DI INTERVENTO	
Progettisti	RUP	Capo Settore	Capo Area
Ing. Roberto Piccolo Geom. Paolo Salmistraro Geom. Laura Ravalico Geom. Silvano Bandiera	Ing. Maurizio Sinigaglia	Arch. Luigino Gennaro	Arch. Luigino Gennaro

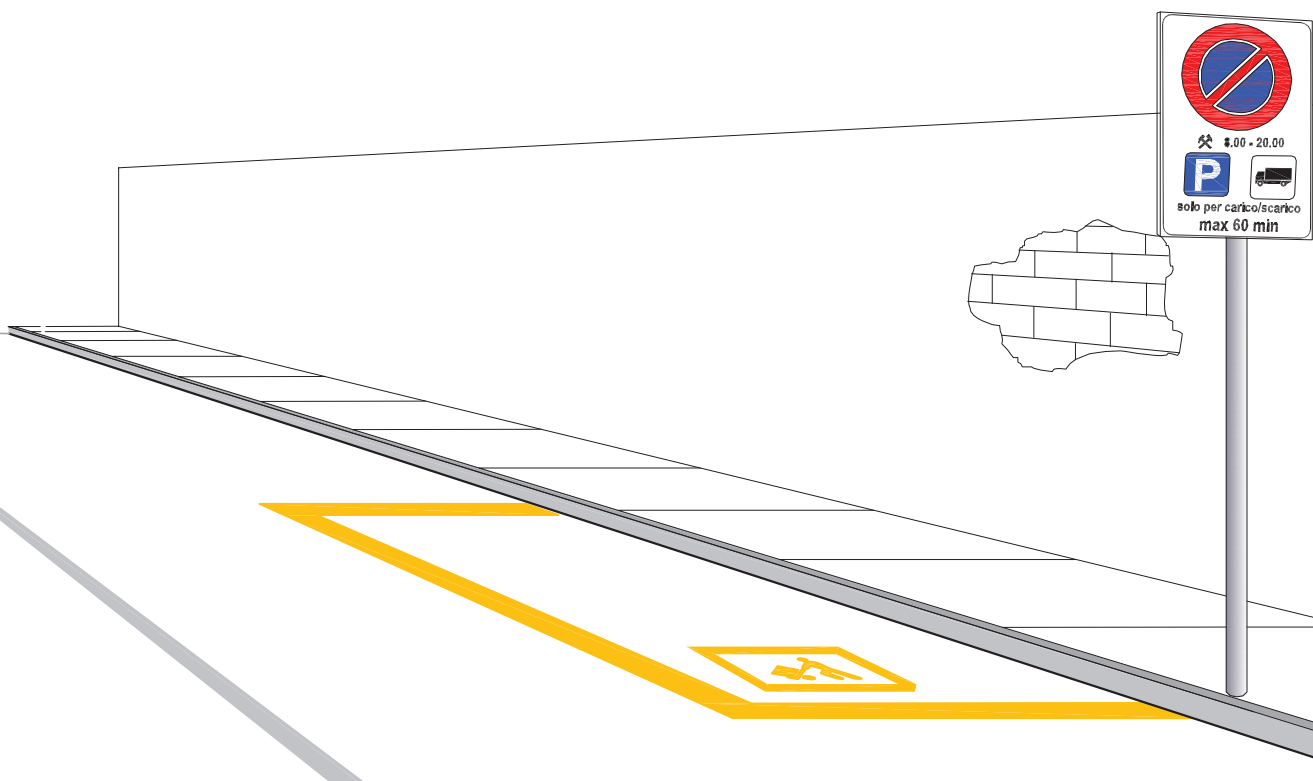

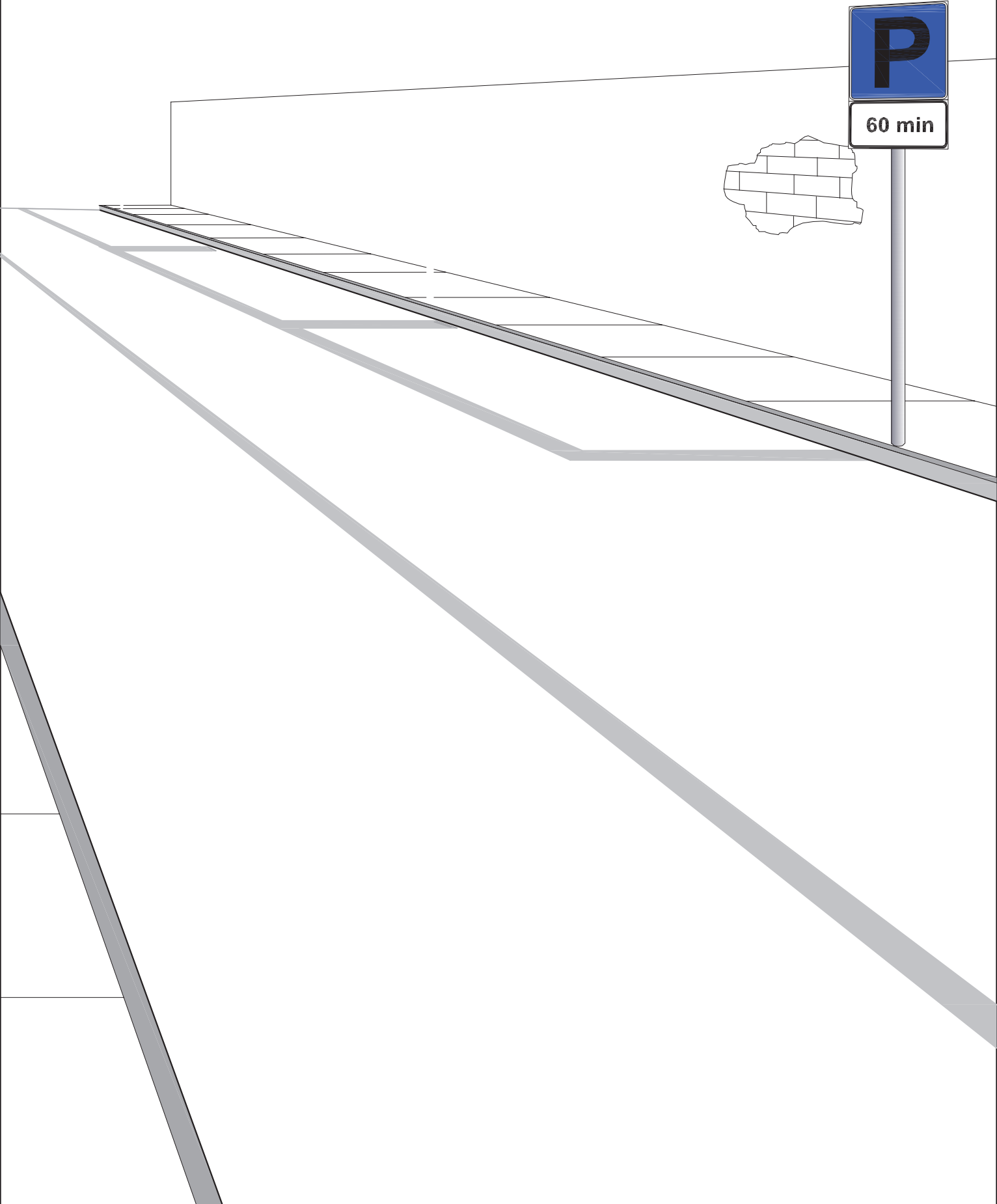

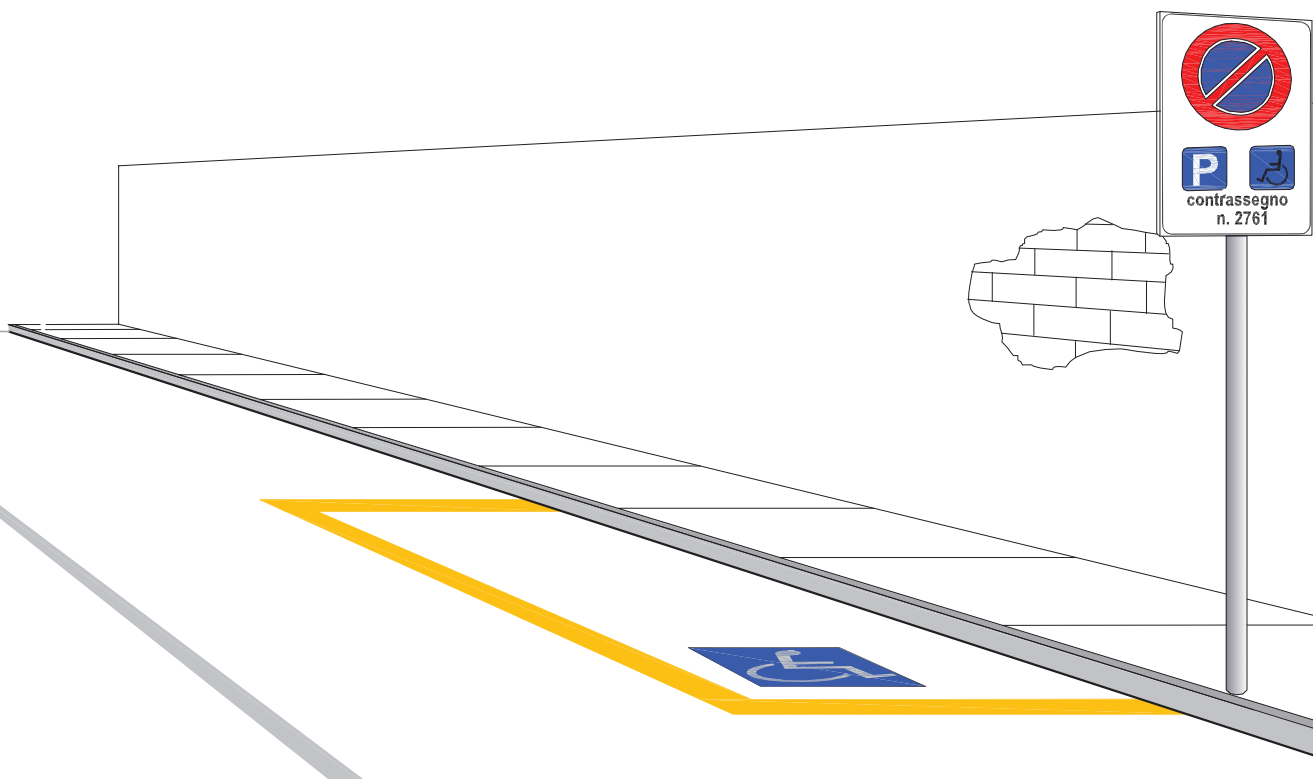

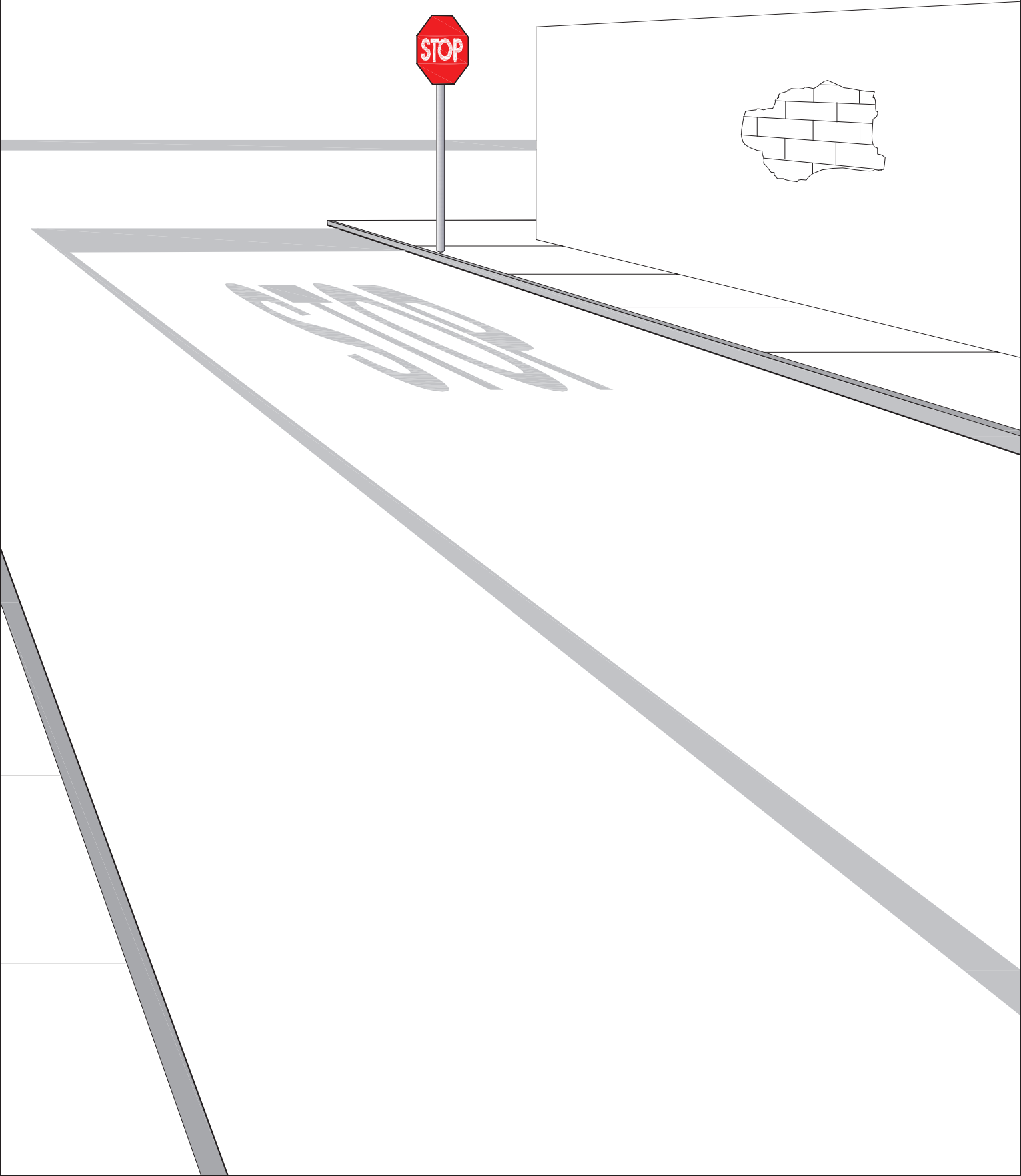



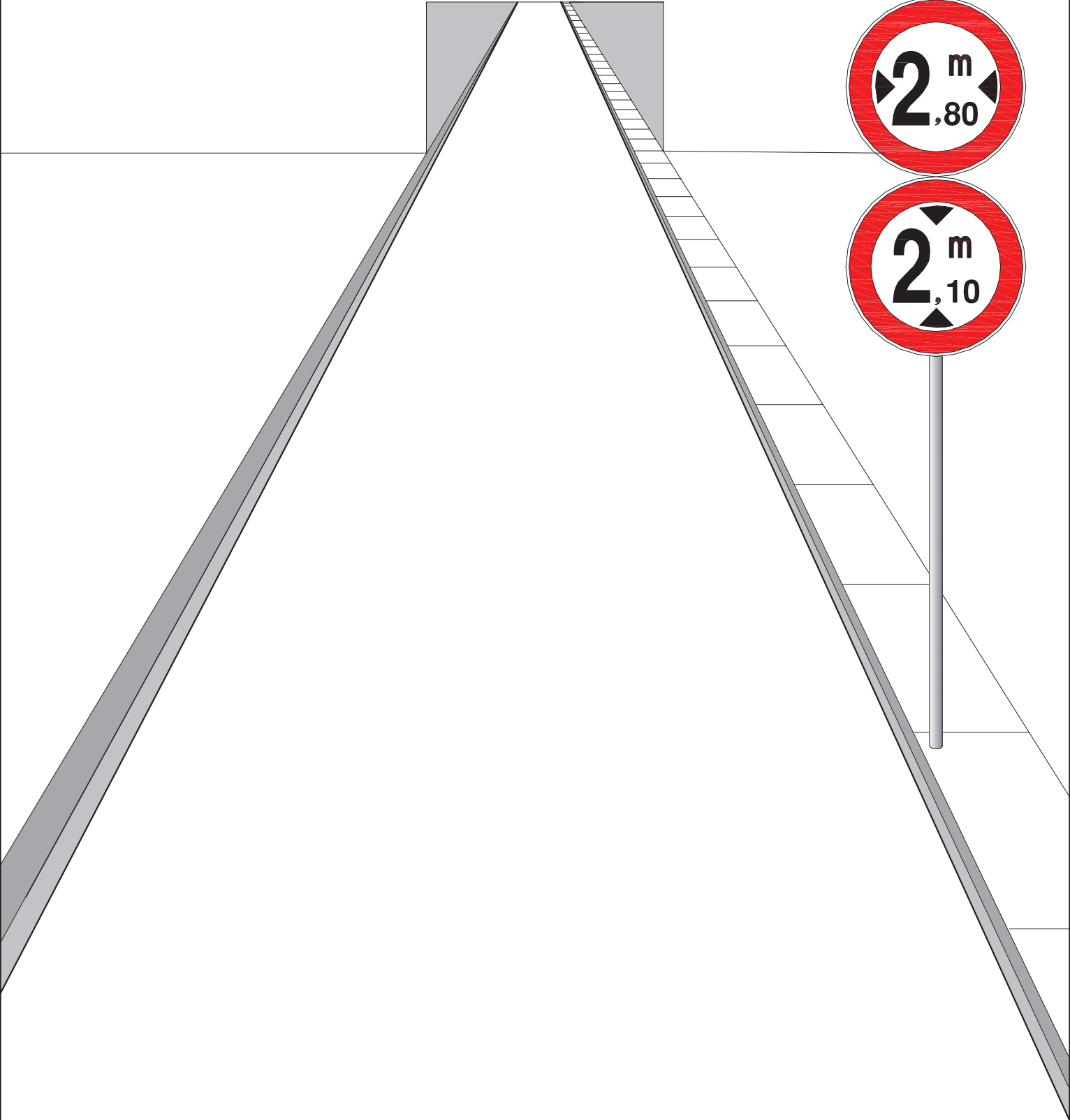

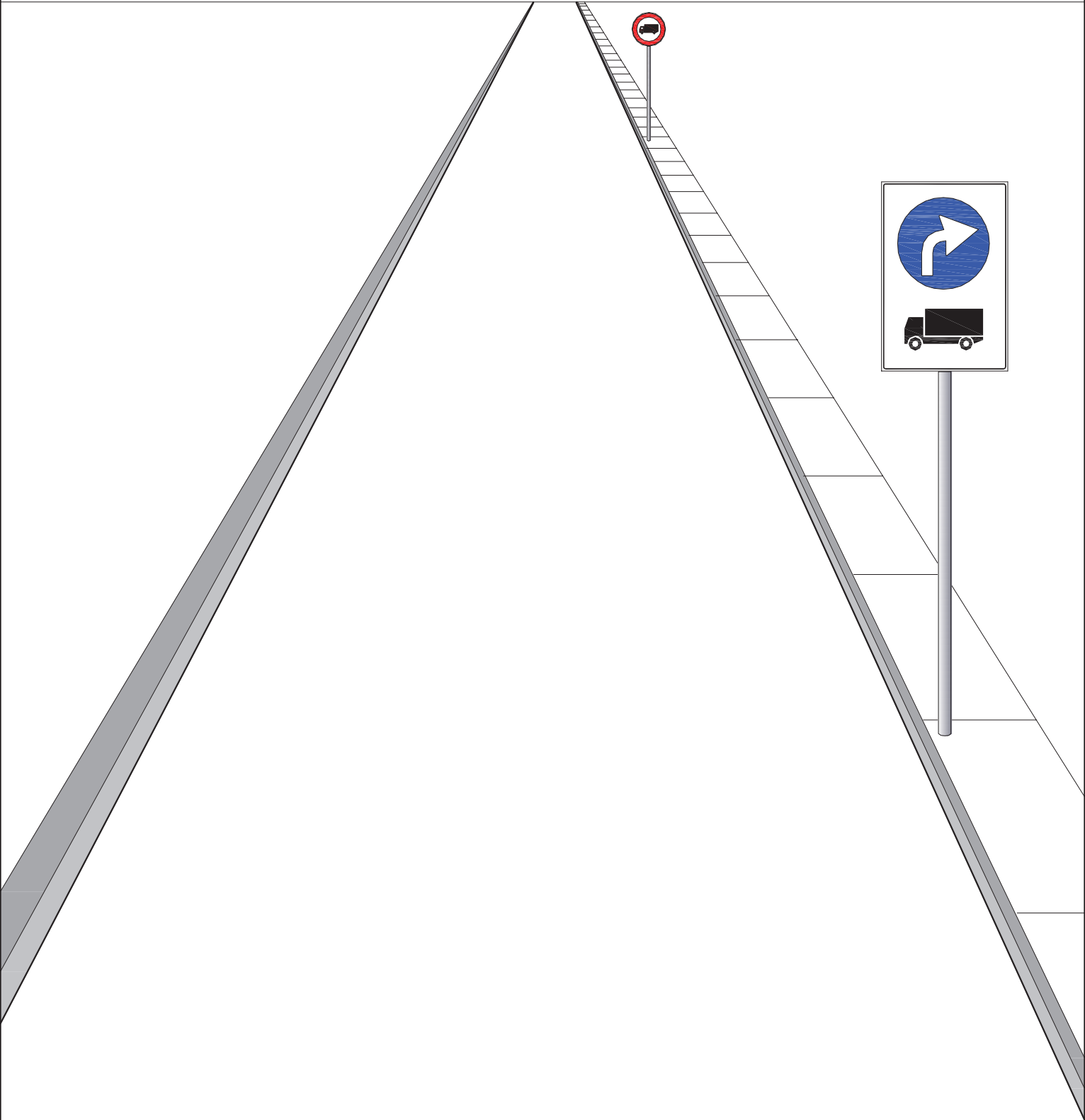





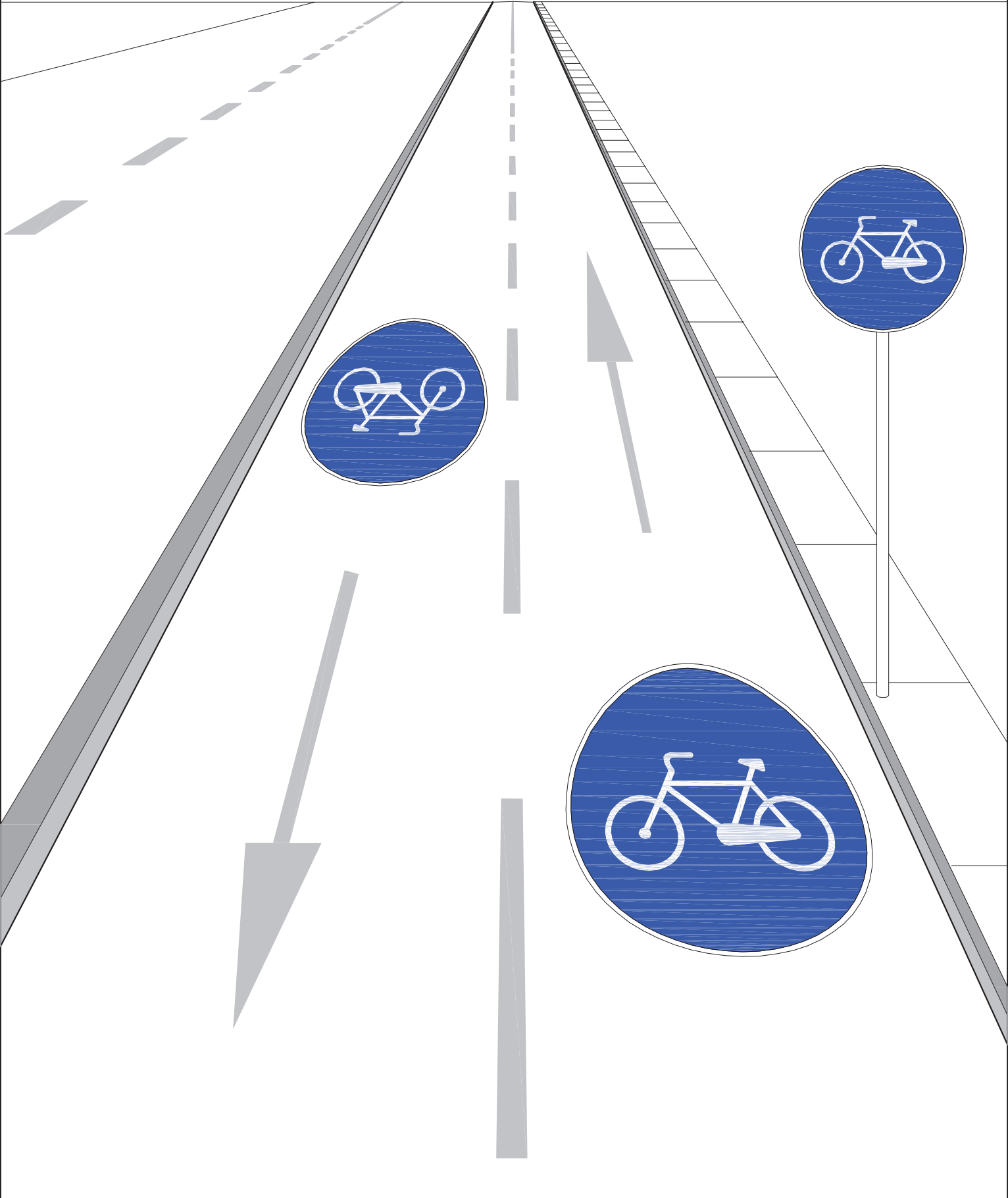

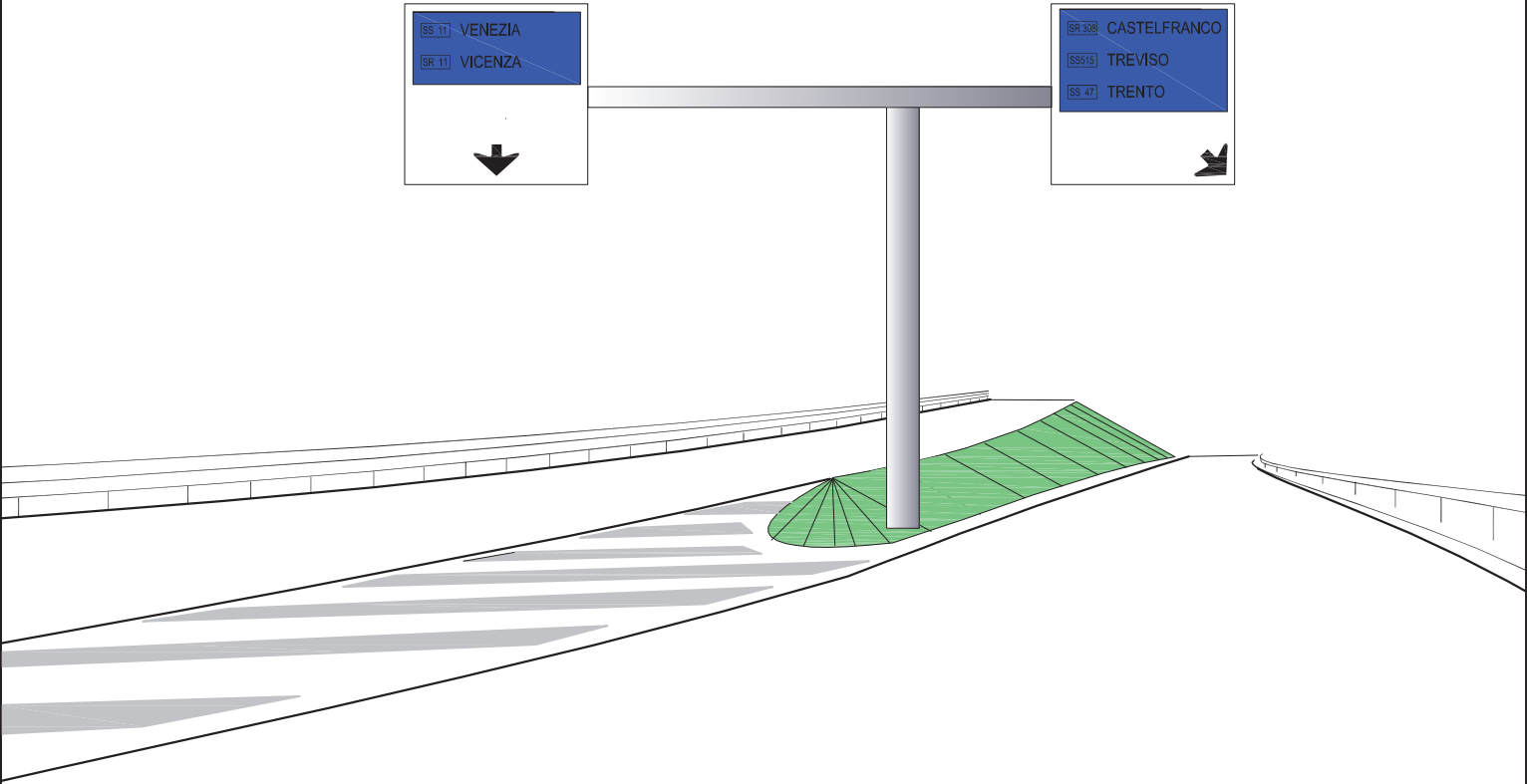



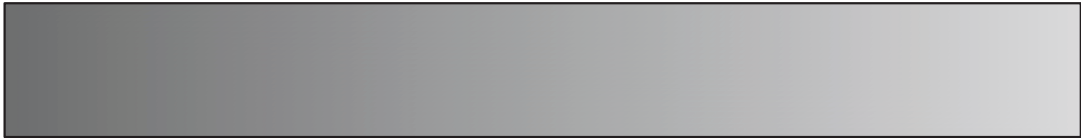
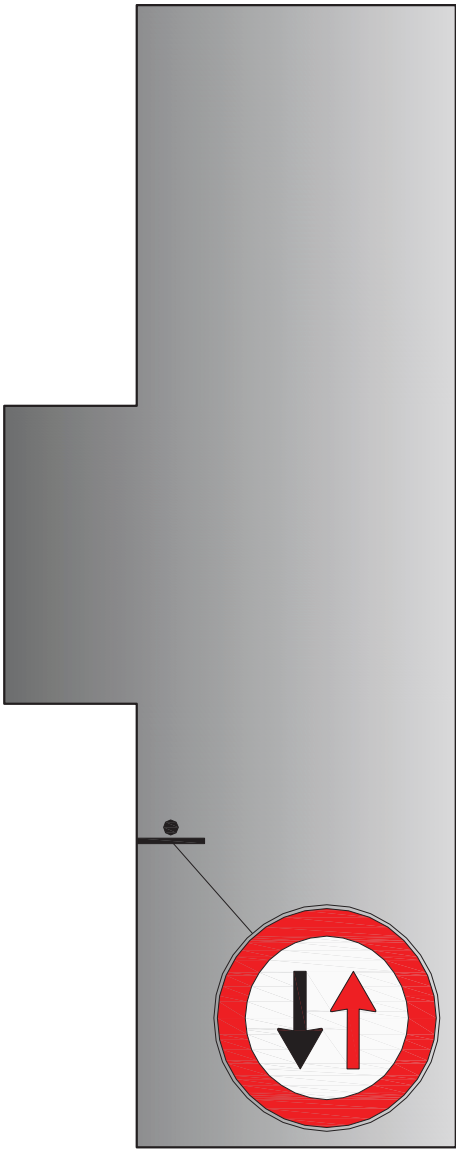
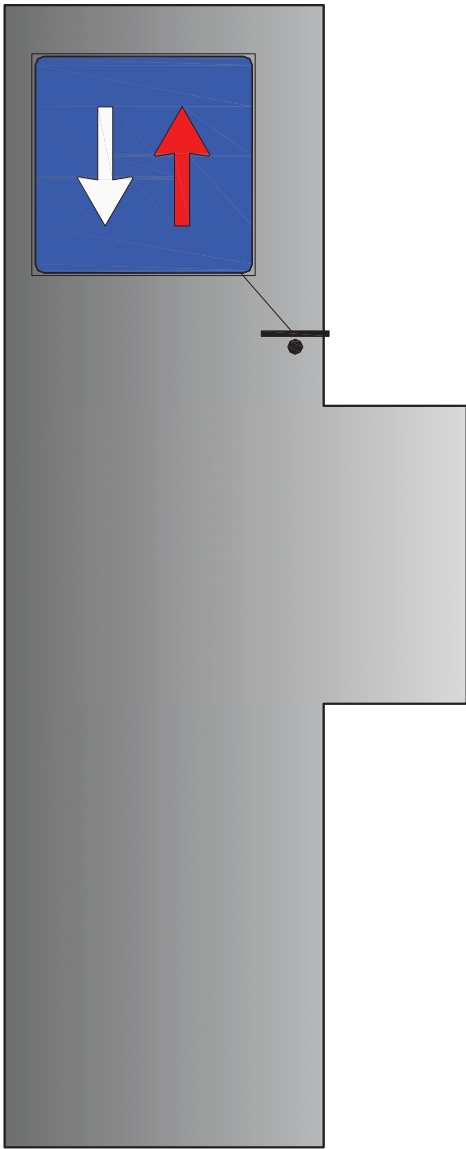

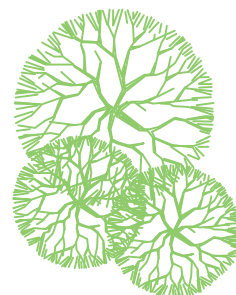
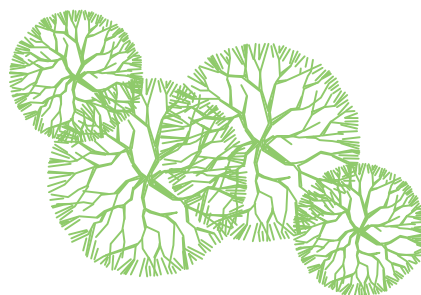
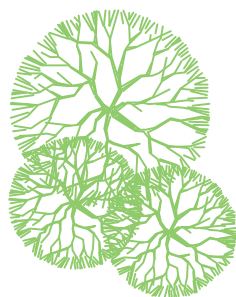
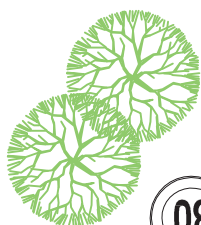

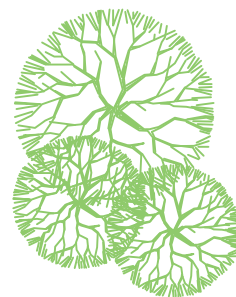
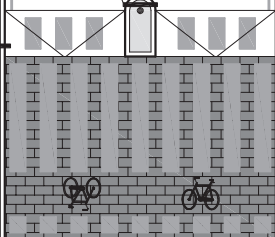
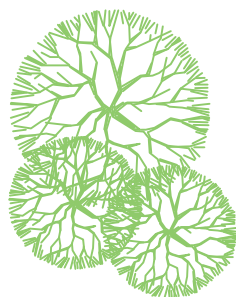
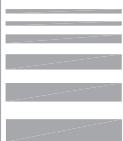
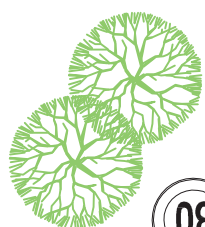

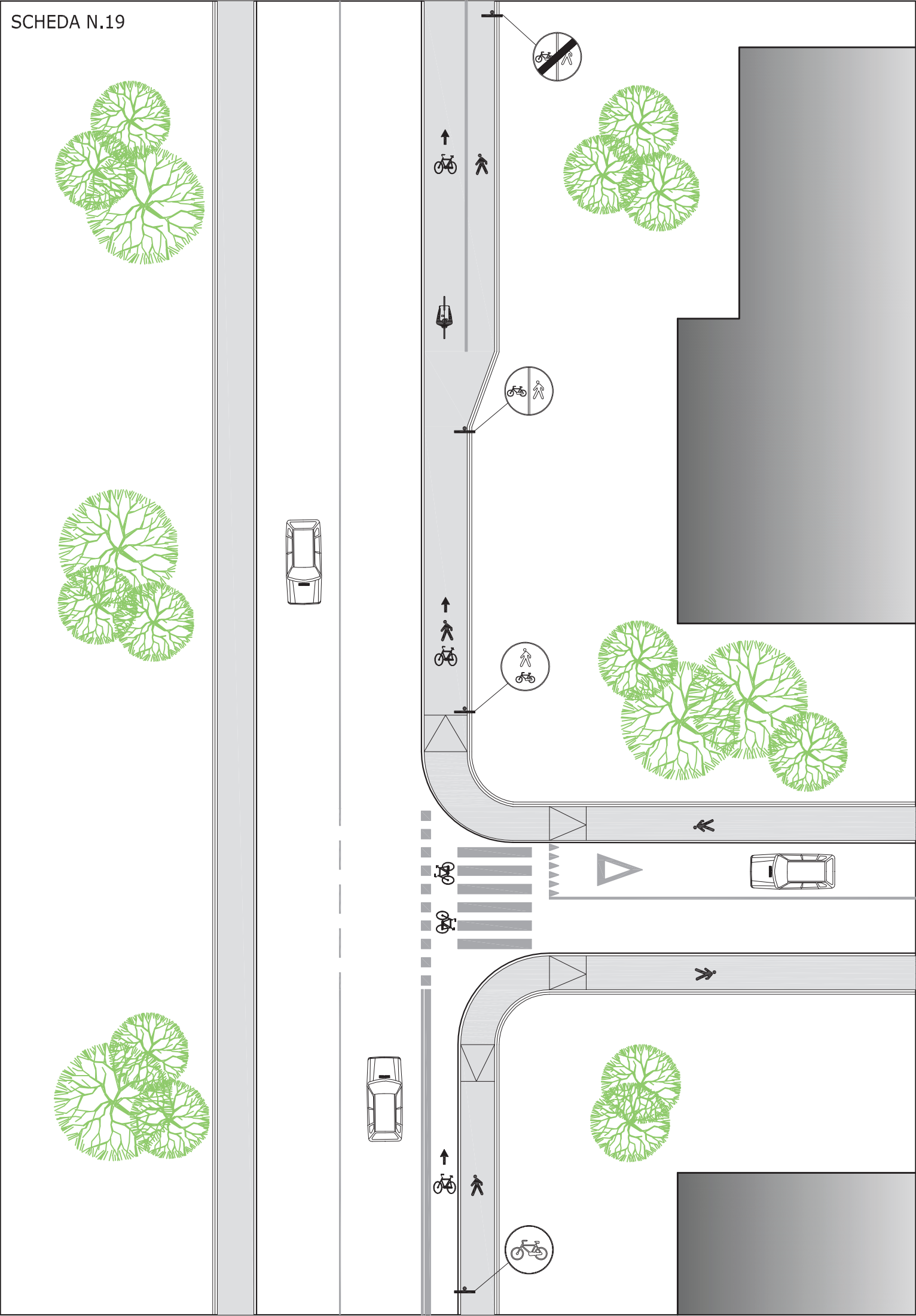

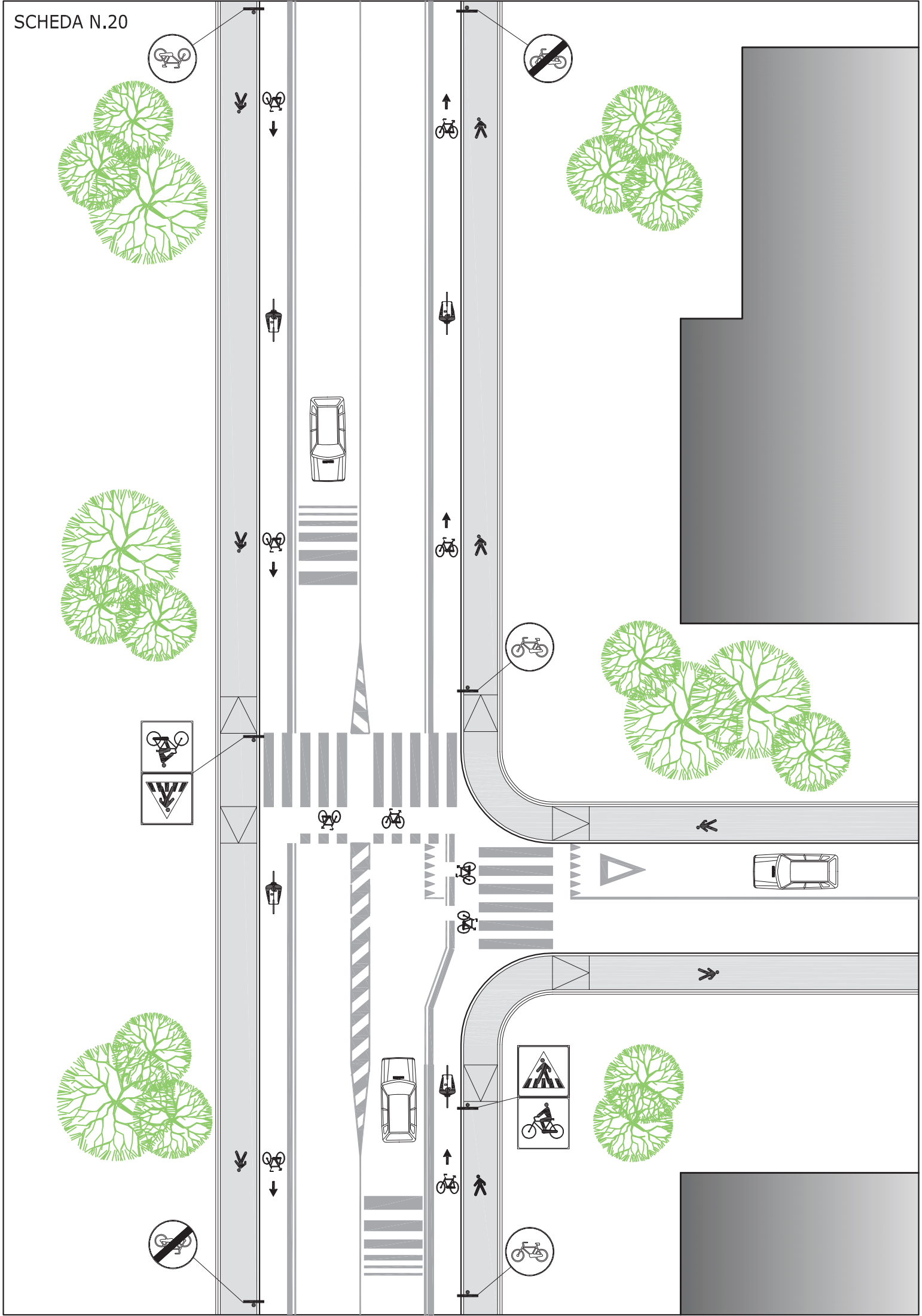

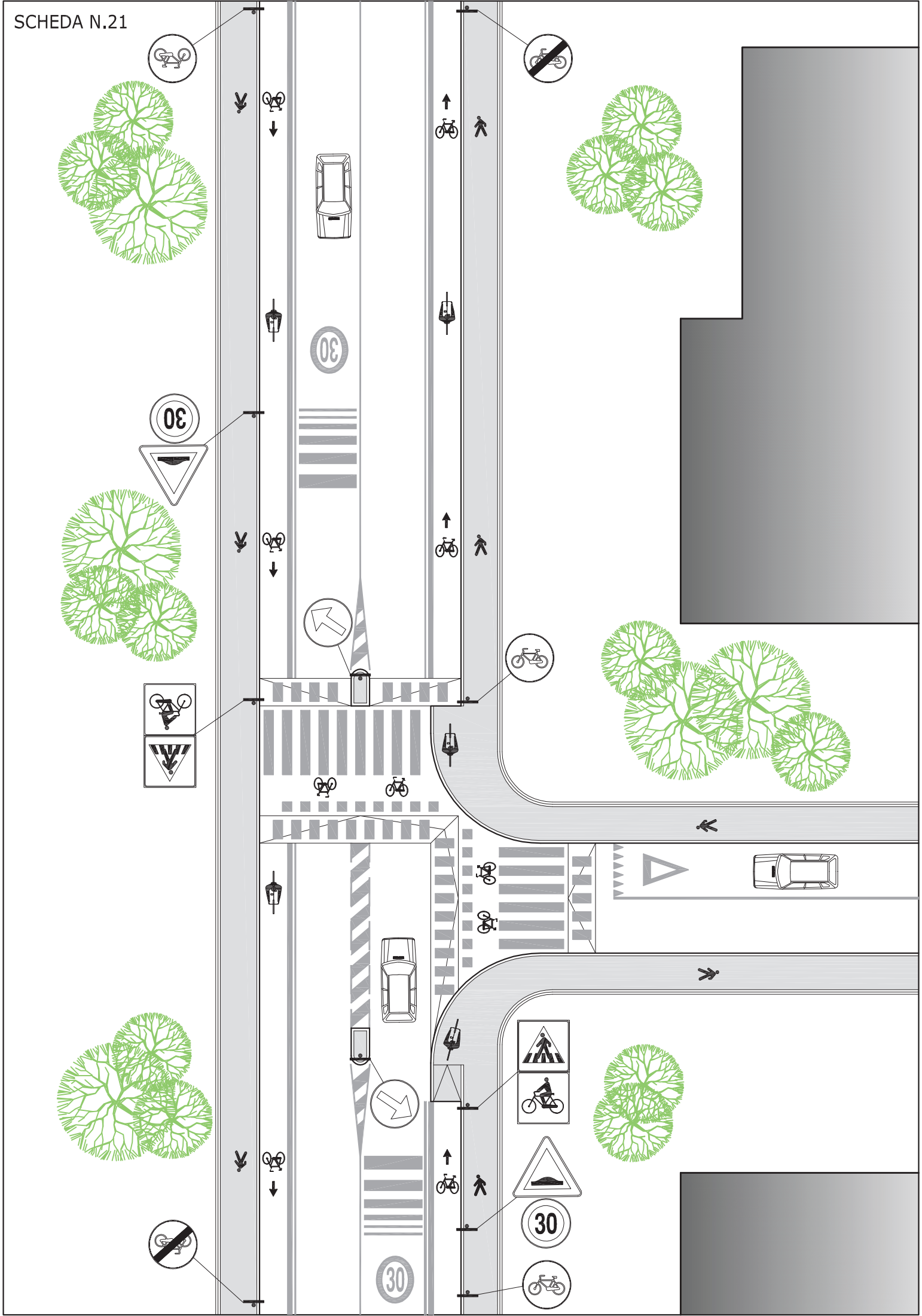

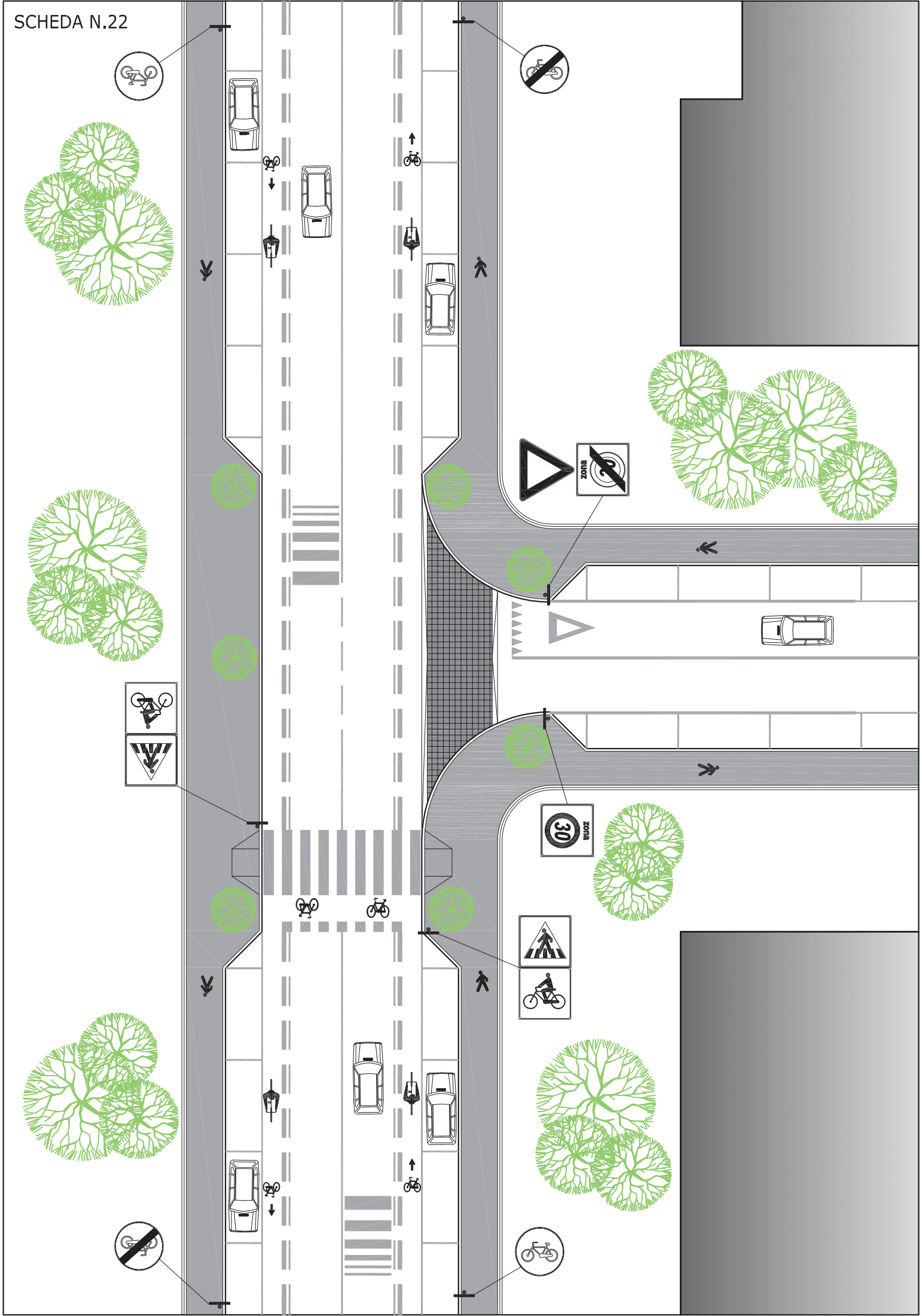

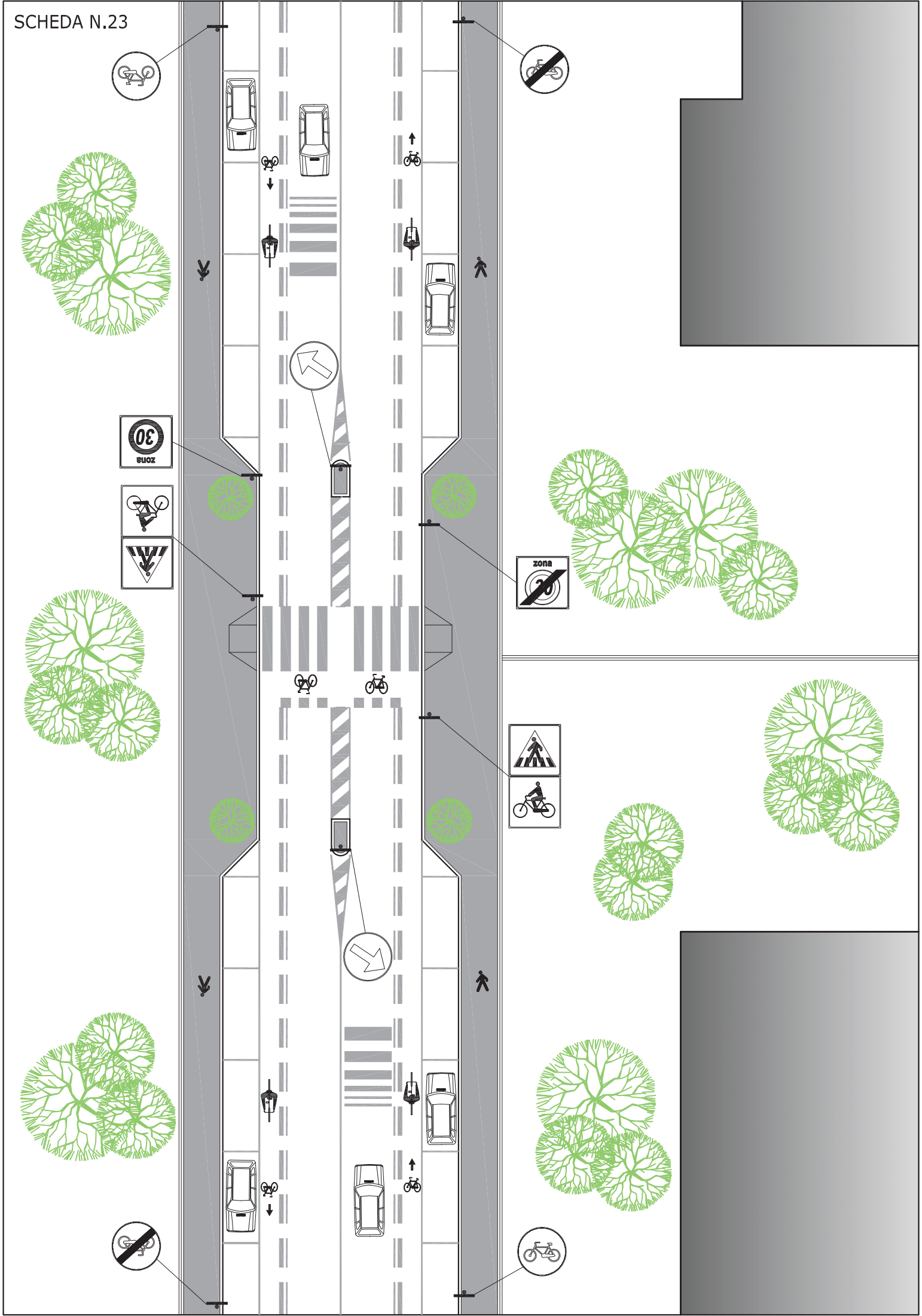

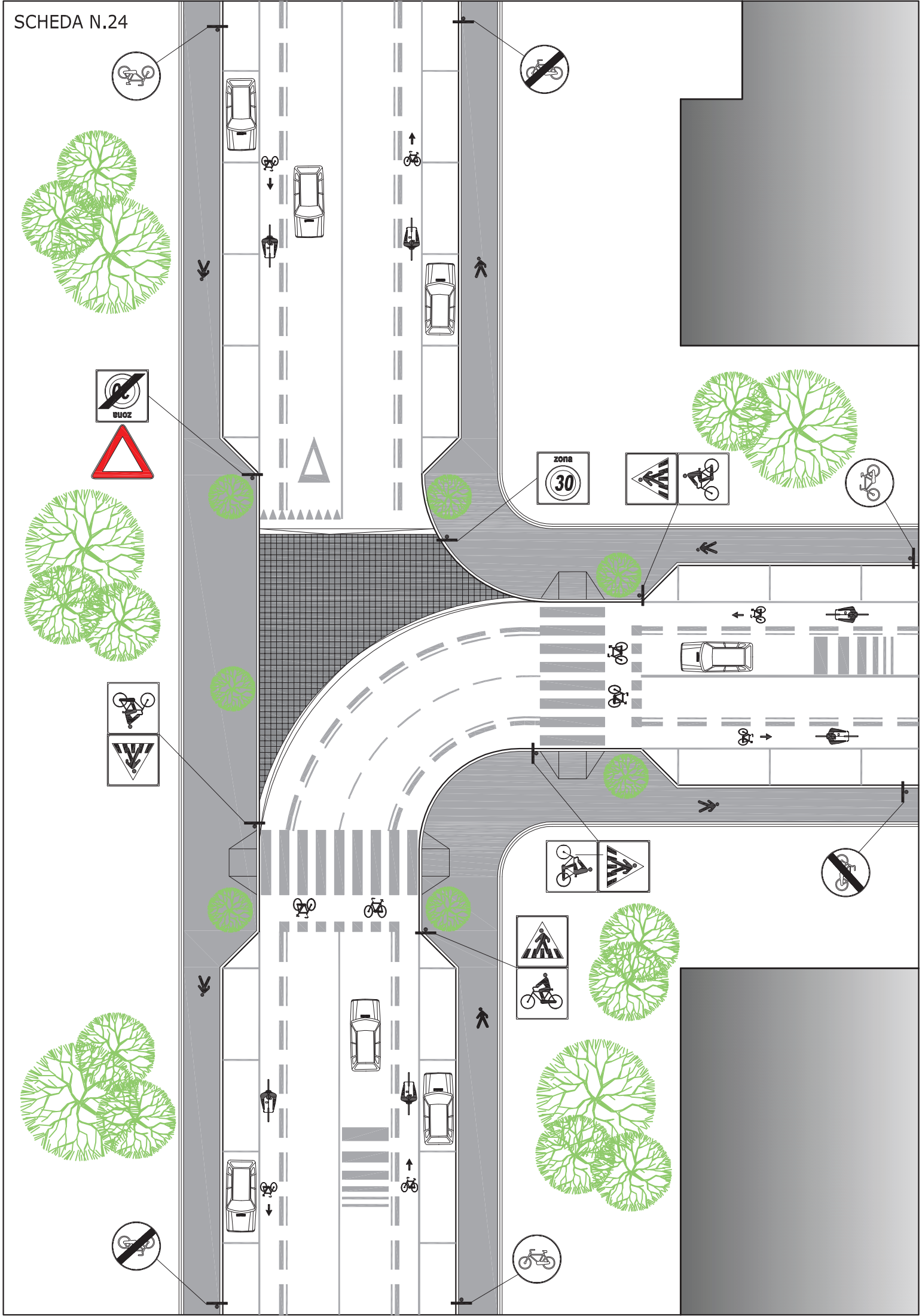

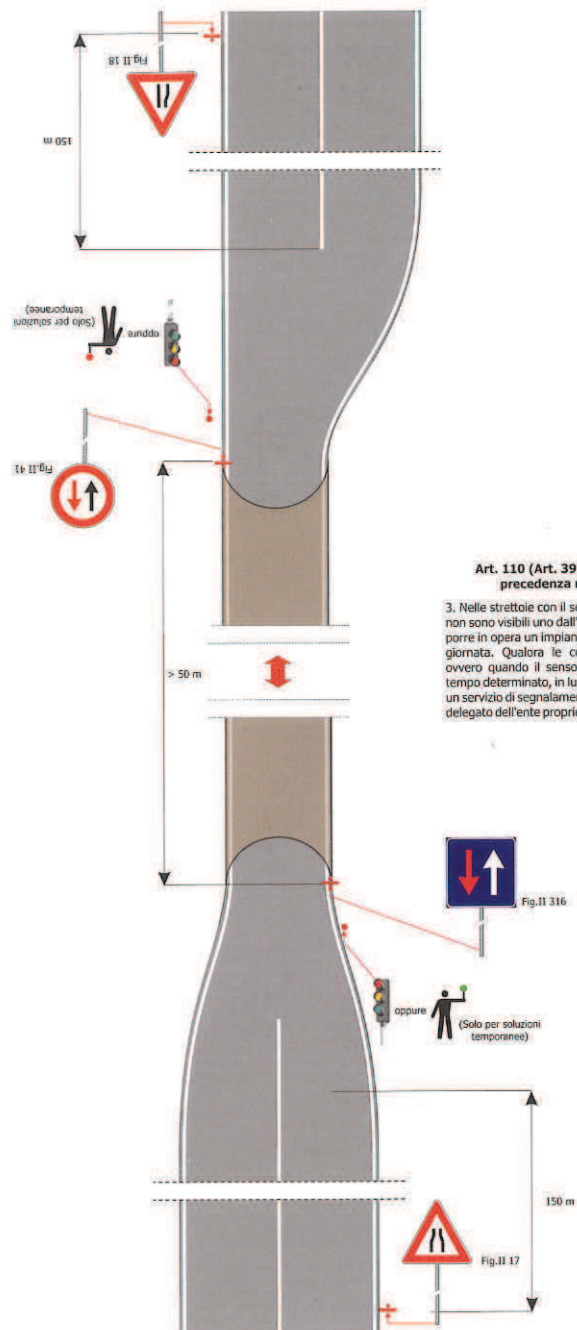

Art. 110 (Art. 39 Cod. Str.) - Segnale di dare precedenza nei sensi unici alternati.

3. Nelle strette con il senso unico alternato ed i cui imbocchi non sono visibili uno dall'altro o che distino più di 50 m, si deve porre in opera un impianto semaforico funzionante per l'intera giornata. Qualora le condizioni del traffico lo richiedano, ovvero quando il senso unico alternato sia attivato per un tempo determinato, in luogo del semaforo può essere disposto un servizio di segnalamento manuale mediante personale a ciò delegato dell'ente proprietario della strada.

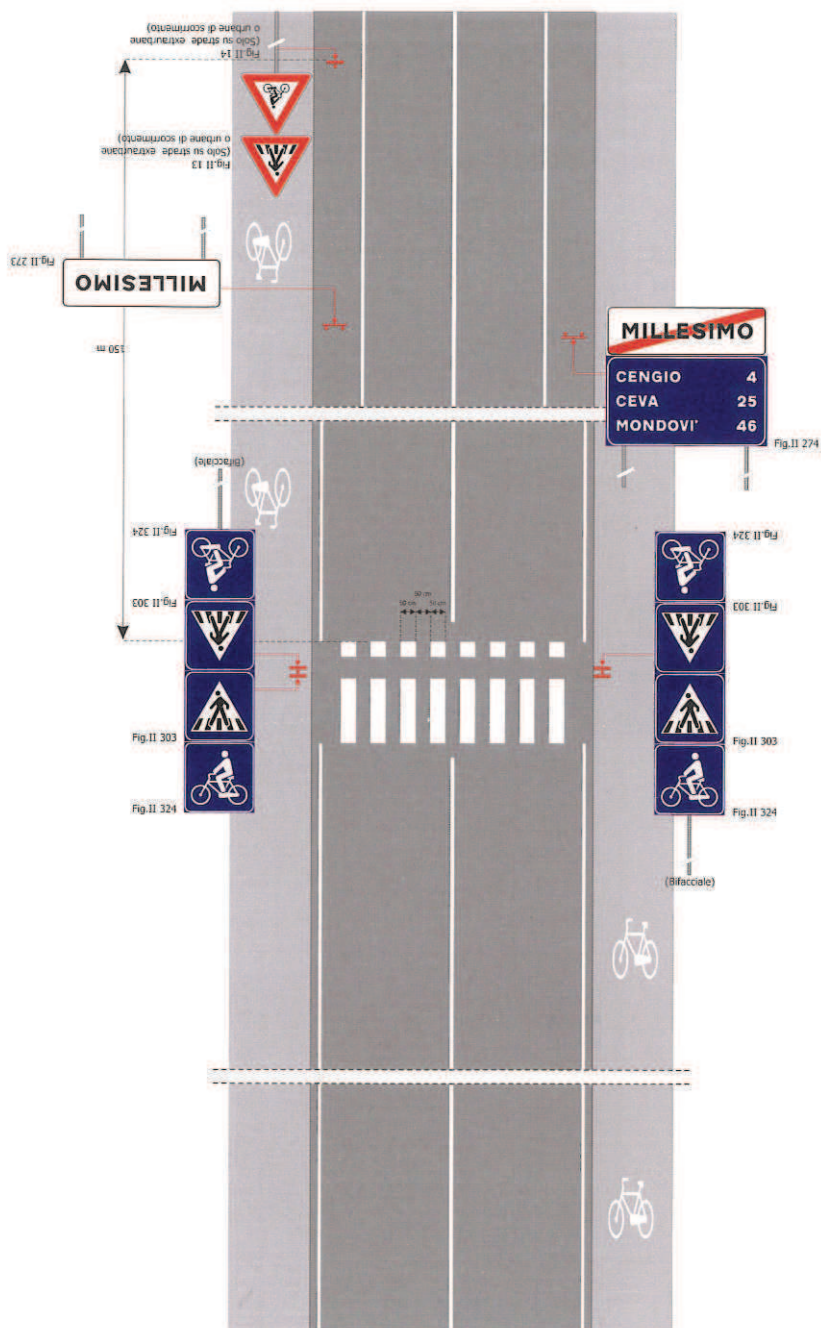

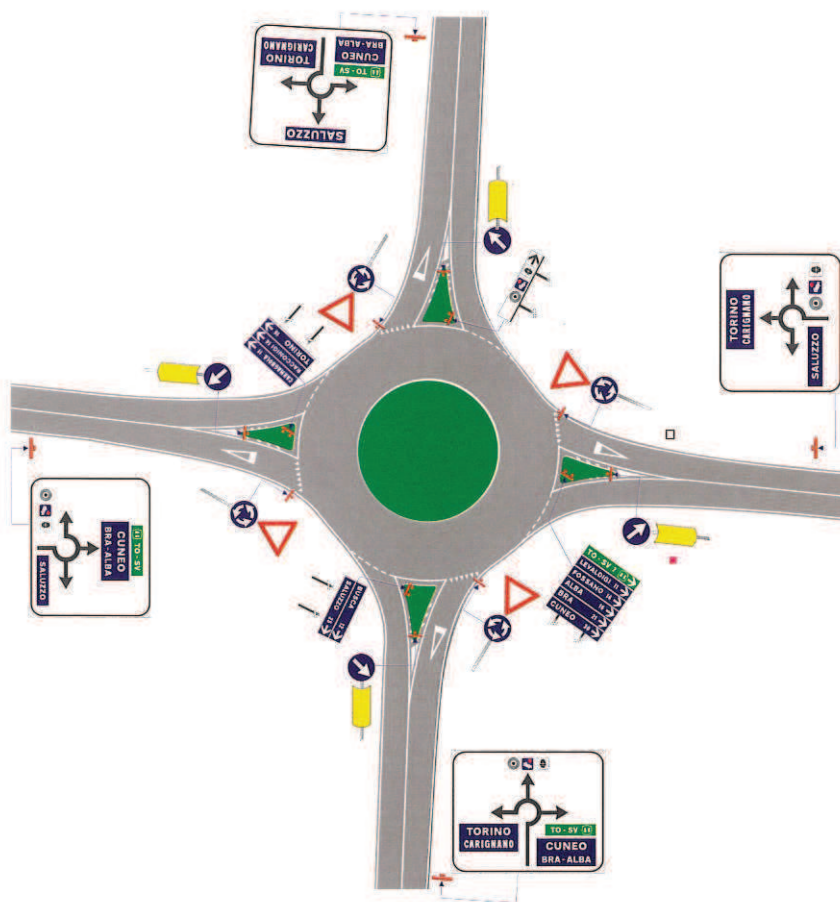

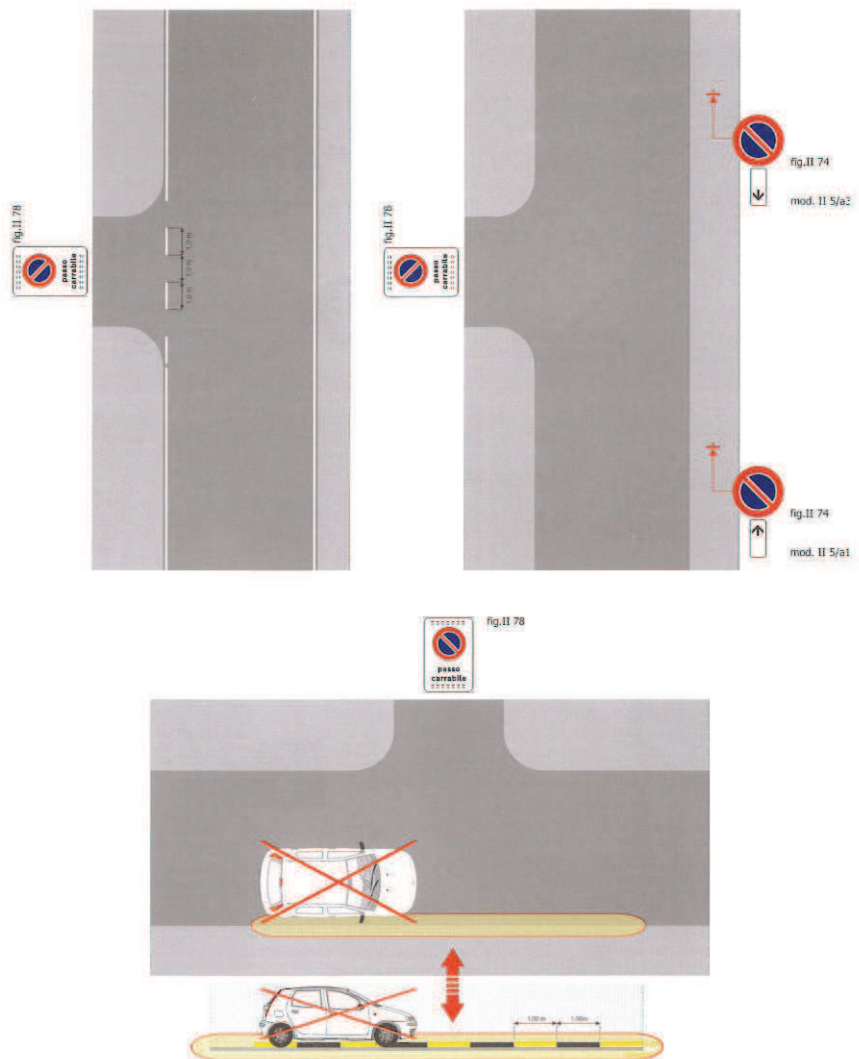

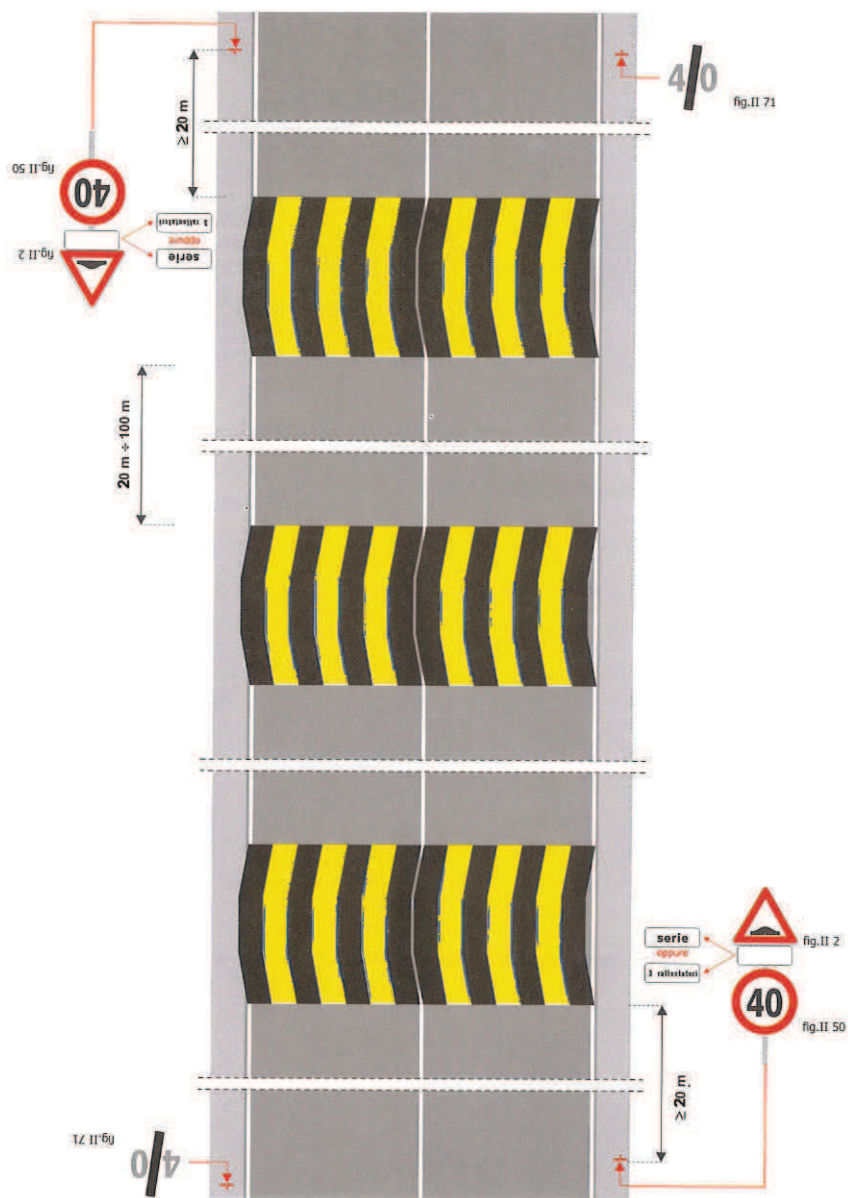



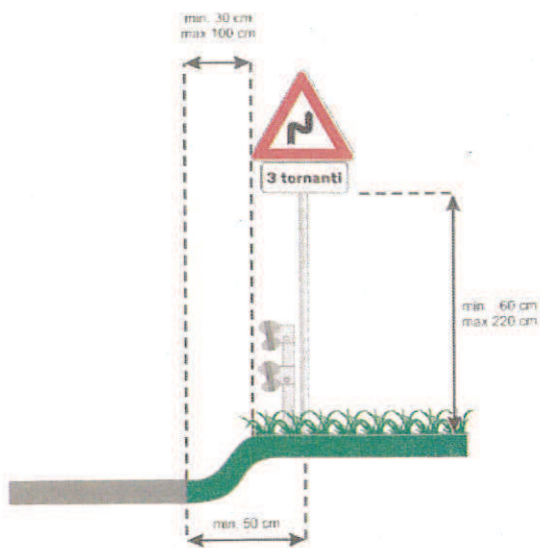

Esempio di Situazione Extraurbana

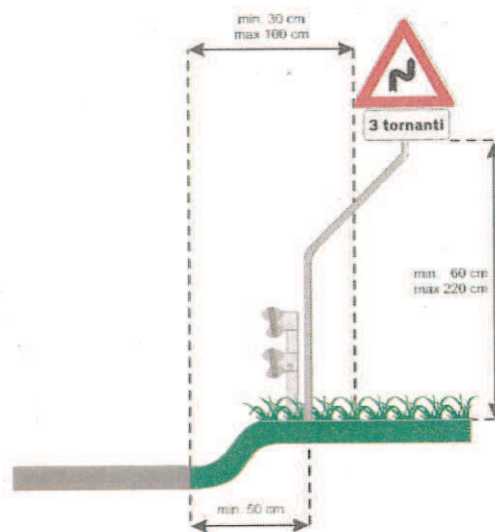

Esempio di Situazione Extraurbana - Sostegno sagomato a "S"

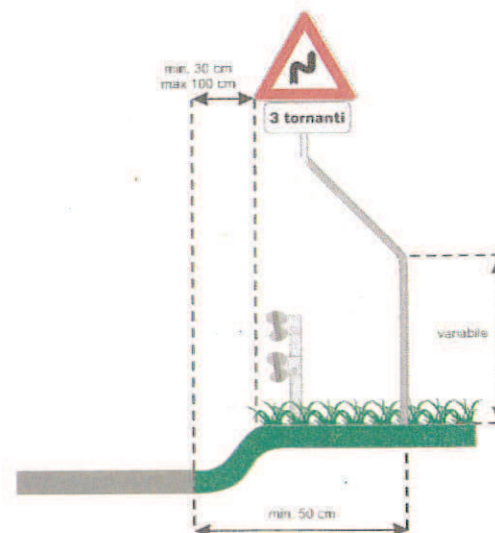

Esempio di Situazione Extraurbana - Sostegno sagomato a "S"



Esempio di Situazione Urbana

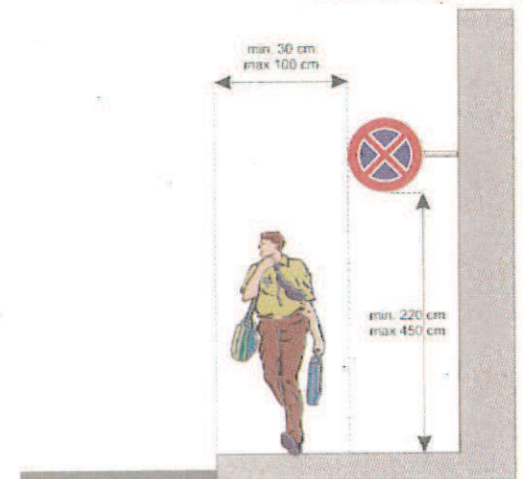

Esempio di Situazione Urbana - Mensola a Palo



Esempio di Situazione Urbana - Sostegno sagomato a "S"

Attraversamento pedonale con preavviso

